

Industrial Multi-camera Drive Recorder RM-100RC Setup Guide

Silex Technology CE UK CA VWA108000XX

Thank you for purchasing the industrial multi-camera drive recorder, "RM-100RC".
RM-100RC supports video recording with up to 4 RTP cameras, and the recorded videos can be checked remotely over the network. Also, it has Wi-Fi 6 (IEEE 802.11ax) Access Point function.

This document describes the initial configuration method and the procedure for checking the recorded videos.

*Camera is not contained in the product package. It need to be purchased separately.

Package Contents

Following items are contained in the product package.

- RM-100RC
- Warranty Guide and GPL Inquiry Card
- Setup Guide (this document)
- Declaration of Conformity (EU/UK model only).
- Rubber foot (4pcs)

Name of Parts

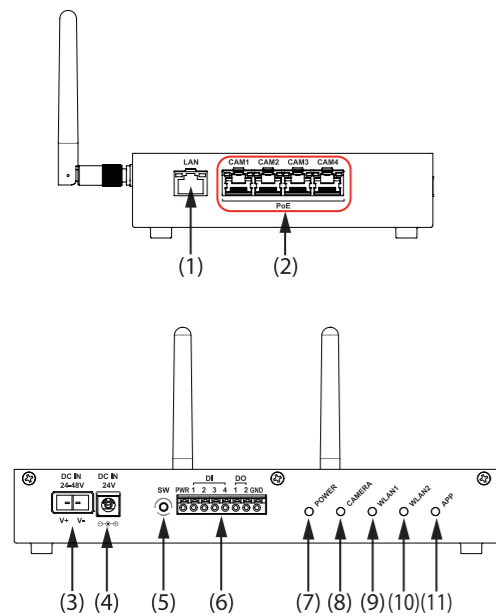

- (1) LAN Port
- (2) CAMERA Port (PoE supported (**))
- (3) DC Connector
- (4) DC jack
- (5) Push Switch
- (6) Digital Input/Output interface
- (7) POWER LED (Green/Orange/Red)
- (8) CAMERA LED(Green/Orange/Red)
- (9) WLAN1 LED(Green/Orange/Red)
- (10) WLAN2 LED(Green/Orange/Red)
- (11) APP LED

* The camera ports are located on the right of the LAN port (1) in the order of camera 1 > camera 2 > camera 3 > camera 4.

For detailed function of each part, please refer to the user's manual.

Necessary Items

Following items are required.

- LAN cable
- PC to use for configuration
- Power supply (DC24V to 48V), or RM-100RC's optional AC adapter

*When there is no power supply that supports DC24V to 48V, please use the optional AC adapter.
*Power supply (DC24V to 48V) and AC adapter cannot be used at the same time.
*To connect to this connector, please use JST's JFA connector J300 series F32F55-02V-KX.
*The pin arrangement for the DC connector of RM-100RC is as follows.

DC Connector

| PIN Number | Signal | Description |
|------------|--------|--------------|
| 1 | DCIN | DC 24 to 48V |
| 2 | GND | GND |

Camera

This document describes the initial configuration and video confirmation procedures for using "IP-S324", which is the standard camera of RM-100RC.

For procedures to use a camera other than the standard camera, refer to the user's manual.

IP-S324 (manufactured by MOTHERTOOL CO.,LTD.)

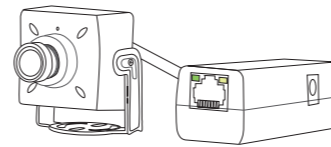

* For the compatible camera information, please visit Silex Technology's website.

How to Configure

Change the wired LAN network setting of the PC to allow communication with RM-100RC.
If the wired LAN network setting of the PC is set to "Obtain an IP address automatically", you do not have to change it since the DHCP server setting of RM-100RC is enabled by default.

Sample network setting)
When the IP address of RM-100RC is "192.168.1.10", change the wired LAN network settings of the PC as follows.
- IP address : 192.168.1.100
- Subnet mask : 255.255.255.0

1 Connect RM-100RC and the camera using a LAN cable.

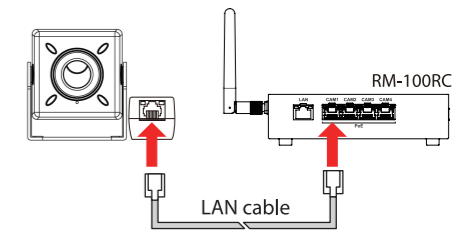

2 Connect the PC and RM-100RC ("LAN" port) using a LAN cable.

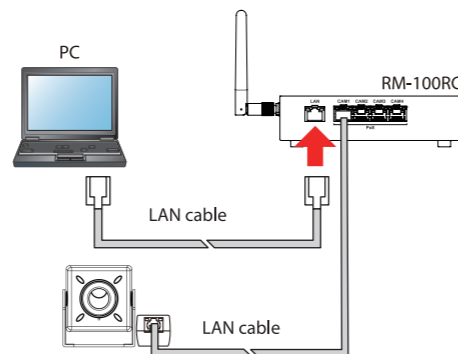

3 Connect the power supply cable to the DC connector of RM-100RC.

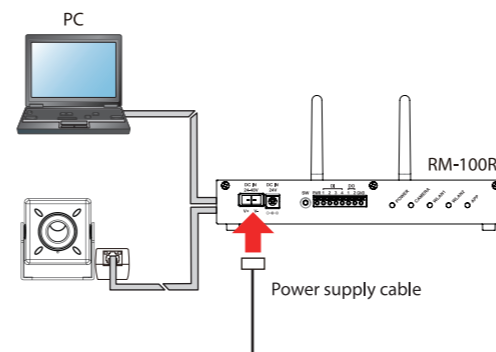

*When the optional AC adapter is used, connect it to the DC jack of RM-100RC. Then, do not use the power supply that supports DC24V to 48V with it.

4 Start the Web browser (Microsoft Edge) on the PC. Enter the IP address of RM-100RC to the address bar and press the Enter key.

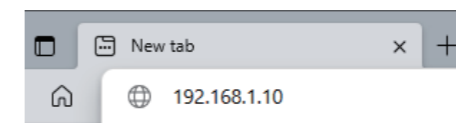

*The default IP address of RM-100RC is "192.168.1.10".

5 The login password configuration page appears, enter the password to configure for RM-100RC and click **Submit**.

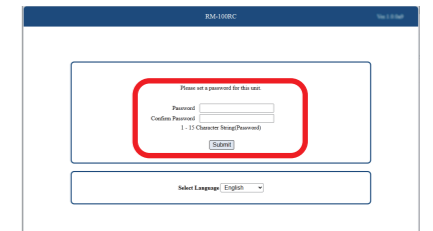

* Make a note of the password so that you can refer when you have forgot it.

* The login password configuration page is displayed only when RM-100RC has the factory default settings. Once configured, it will not be displayed again.

6 The login page is displayed. Enter the login password you have configured and click **Login**.

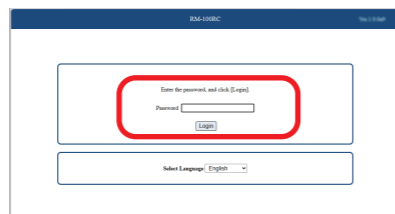

7 The Web page of RM-100RC is displayed. Click **Required Conf.** from the menu.

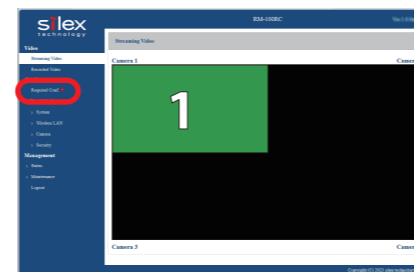

8 The **Required Configuration** page is displayed. Check the system time and change it if necessary.

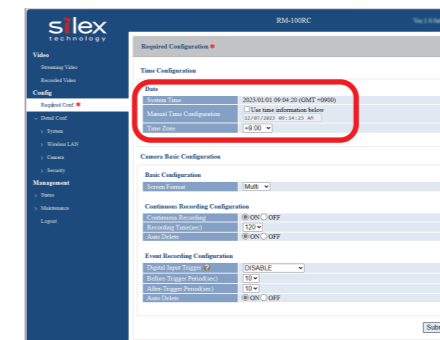

9 Check the settings at **Camera Basic Configuration**. Change the settings if necessary. When no settings need to be changed, you can skip the the following steps.

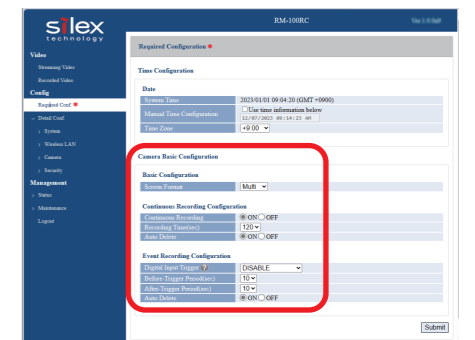

*For details on each configuration item, refer to the user's manual.

10 Click **Submit** at bottom right of the **Required Configuration** page.

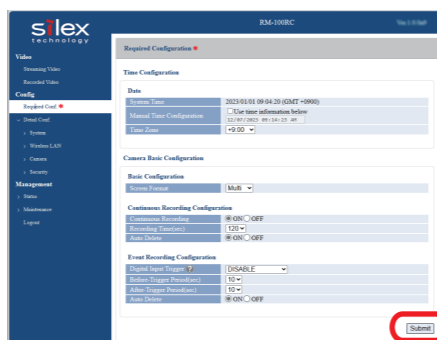

11 Click **Restart** at the top of the **Required Configuration** page, or go to **Management - Maintenance** and click **Restart**.

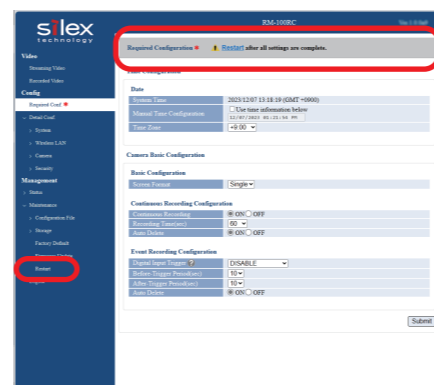

12 When the **Restart** page is displayed, click **Restart**.

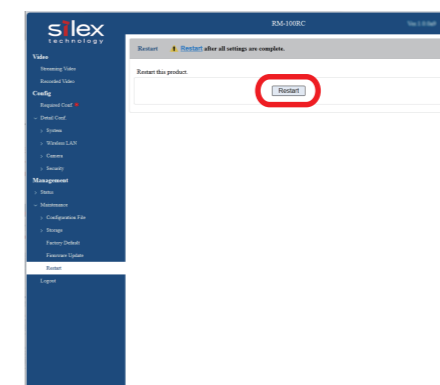

13 RM-100RC will restart. When the login page is displayed, the restart is completed.

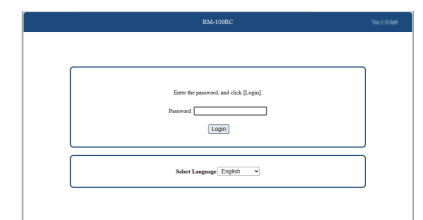

The initial configuration for RM-100RC is now completed. Go on to the back page for how to check the recorded files.

Checking the Recorded Files

The following explains how to check the recorded files.

- 1 Start the Web browser (Microsoft Edge) on the PC. Enter the IP address of RM-100RC to the address bar and press the Enter key.

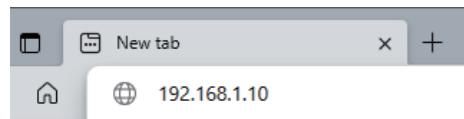

- 2 The login page is displayed. Enter the login password you have configured and click **Login**.

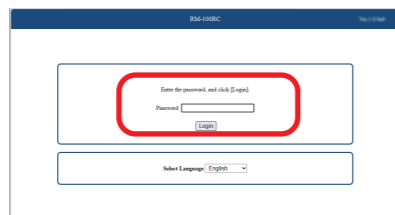

- 3 The **Streaming Video** page is displayed. Click **Required Conf.** from the menu.

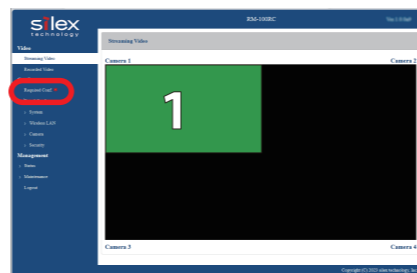

- 4 The **Required Configuration** page is displayed. Check the check box of **Use time information** below, and click **Submit**.

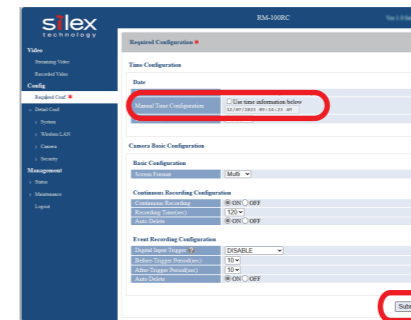

* When the other settings have been changed, RM-100RC needs to be restarted.

- 5 Confirm that the **System Time** has been updated as specified, and click **Streaming Video** from the menu.

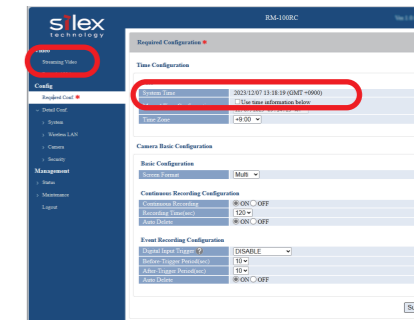

- 6 The **Streaming Video** page is displayed. Check the video of the camera connected to RM-100RC. When the time of **Recording Time (sec)** has elapsed, click **Recorded Video** from the menu.

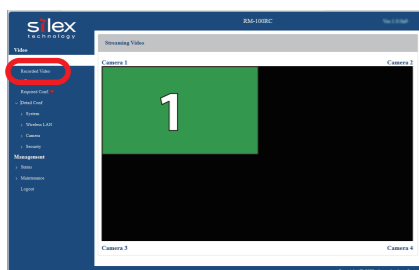

* It may take a while until the video of the camera is displayed.
* If a camera is not connected or an image is not obtained from the camera, that camera area will be black.

- 7 The **Recorded Video** page is displayed. Click **normal**.

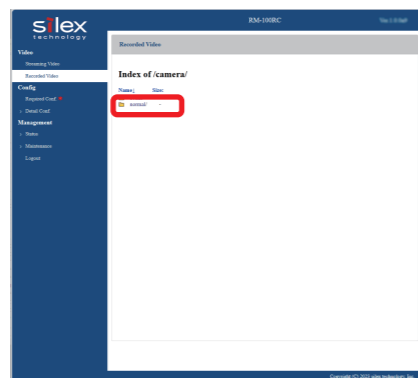

- 8 The contents of the **normal** folder are displayed. Click the folder with the date that the recorded file is created.

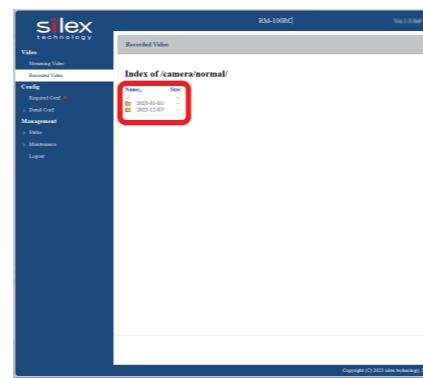

- 9 The saved recorded files are listed. Click the file to download it, and check the contents of the file.

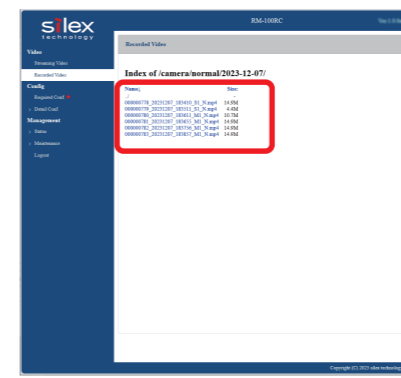

*The name of the recorded file is as follows.

nnnnnnnnn_YYYYMMDD_hhmmss_SN_T.mp4

nnnnnnnnn: Recorded order
YYYYMMDD: Recording start date (YYYY:year, MM:month, DD:date)
hhmmss: Recording start time (hh:hours, mm:minutes, ss:seconds)
S: File save method
M: Multi, S: Single
N: Camera number
If the recorded file is from the camera connected to camera port 1, the number will be 1.
If the file save method is Multi, it is fixed to 1.
T: Record type
N: constant recording,
Dn: event recording ('n' represents the digital input number)

If the recorded file is created according to the instructions in this document, the file name will be as below.
00000040_20231107_174816_M1_N.mp4

You have now finished checking the recorded files.
For details on other functions and settings, refer to the user's manual.

Factory Default Configuration

Follow the instructions below to reset RM-100RC to the factory default setting.

- 1 Remove the power supply cable from RM-100RC.

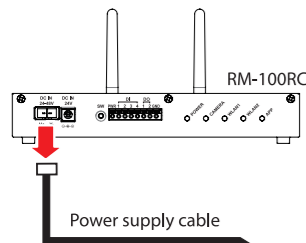

- 2 Press and hold the push switch of RM-100RC (1) while inserting the power supply cable into the DC connector (2). Keep pressing the push switch.

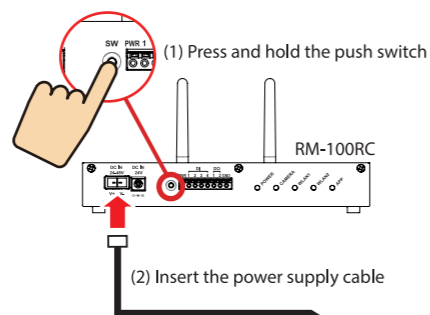

- 3 The LEDs will turn orange one by one, starting with the POWER LED. When all 5 LEDs turn orange (1), release the push switch (2).

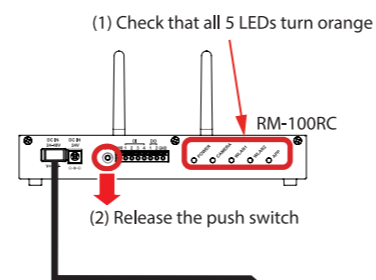

*If the push switch is pressed for 15 sec or longer even after all 5 LEDs turn orange, RM-100RC will start normally without performing the factory default configuration.

- 4 The factory default configuration begins. When the POWER LED of RM-100RC turns green or blinks green, the factory default configuration is completed.

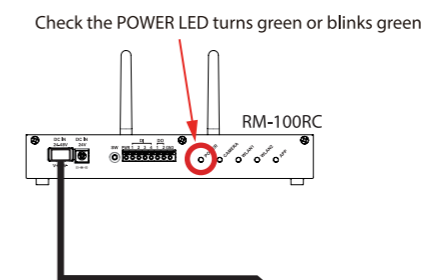

RM-100RC has been reset to the factory defaults.

Downloading User's Manual

The user's manual can be downloaded from the Silex Technology's website. Access the URL below to download it.

<https://www.silextechnology.com/>

- 1 When the website is displayed, click **Support Center** in the bottom of the page.
- 2 Select the product model and download the user's manual.

Trademarks

- Wi-Fi is a registered trademark of Wi-Fi Alliance.
- Microsoft, Microsoft Edge are registered trademark of Microsoft Corporation in the United States and/or other countries.
- Other company names and product names contained in this document are trademarks or registered trademarks of their respective companies.

Customer Support Center

If you have any questions, please contact us at the following.

Customer Support Center information

| | E-mail |
|--------|--|
| USA | support@sillexamerica.com |
| Europe | support@sillexeurope.com |